



# The Grapevine

March 2021 Redwood Empire ASHRAE Section Newsletter

## REASHRAE Joint Meeting

**March 10<sup>th</sup> 2021**

Our upcoming meeting will be jointly hosted with Golden Gate and San Jose ASHRAE. We will hear from National ASHRAE president Charles E. Gullledge. We look forward to seeing you there.

### Inside:

Upcoming Meeting	Pg. 2
President's Message	Pg. 3
Scholarship Recipients	Pg. 4
ASHRAE Membership	Pg. 6



National ASHRAE has released recommendations for best practices for back to school COVID-19 procedures:  
[ASHRAE Epidemic Task Force Reopening Guide for Schools](https://www.ashrae.org/covid19)  
[www.ashrae.org/covid19](https://www.ashrae.org/covid19)

**March 10<sup>th</sup>, 2021**  
**REASHRAE Joint Meeting**



# An evening with our ASHRAE President

Charles E. Gulledge III, P.E., HBDDP, LEED AP, Fellow ASHRAE, is ASHRAE's President for the 2020-21 term. Gulledge previously served on the ASHRAE Board of Directors as president-elect, treasurer, vice president and director-at-large. For his time and dedication to ASHRAE and the industry, he is the recipient of numerous awards including the Exceptional Service Award, Distinguished Service Award, Chapter Service Award, Regional Award of Merit, two ASHRAE Technology Awards and the Dan Mills Technology Award.

His theme for the 2020-21 ASHRAE Society Year is *"The ASHRAE Digital Lighthouse and Industry 4.0."*

"Why should we engage in digital transformation? To gain a competitive advantage amongst our peers, position ourselves as the go-to resource for clients, improve margins, provide greater value, and attract and retain a digitally skilled workforce."

In addition to his time served on the Board of Directors, Gulledge has served as chair of the Members Council and the President-Elect Advisory Committee, chair of the Finance

Committee, chair of the Standards Membership Ad Hoc Committee, chair of the Development Committee for Fundraising, and as an ASHRAE Distinguished Lecturer. He has held ASHRAE Society-level leadership roles on many standing committees, technical committees and presidential ad hoc committees.

Gulledge's theme focuses on reimagining the building industry and ASHRAE's place in it by integrating not only industry segments, but also technology.

"Digital transformation is not simply associated with adopting new technical solutions. Knowledge needs to be captured and linked in such a way that ALL relevant stakeholders' benefit. Doing so requires understanding of how to collect, store, and analyze data; so that it is insightful and actionable."

In addition to his contributions to ASHRAE, Gulledge's career in HVAC spans over 36 years. He is currently a Senior Mechanical Engineer with Environmental Air Systems, LLC. Gulledge's comprehensive design, construction and operational portfolio covers a variety of market sectors.



*Charles "Chuck" E. Gulledge*

ASHRAE President

## Online format:

Link will be provided upon registration

## Meeting Schedule:

5:00 PM Main Program

## Tickets:

20\$ Chapter Members

25\$ Non-Members

## Please register:

<https://ggashrae.org/meetinginfo.php?id=170&ts=1614227602>

# President's Message Spring 2021

Greetings!

I hope you all are doing well and staying safe. It has been an interesting year to say the least, but it feels good to finally see some light at the end of the tunnel. I'm sure it has been a tough year for most, but I want to thank each and every one of our members for the support this past year.

It's been a tough year for REASHRAE. We've had to host all of our meetings virtual, which means we haven't been able to see each other's beautiful faces for 12 months! And that's my favorite part about ASHRAE, being able to get together with everyone a few times a year. We were unable to host the golf tournament this past fall, which is our main source of funding for our scholarship program (and by far the most fun event we host every year).

But, we have endured. We received some generous donations from a few of our members, as well as a massively generous donation from Peterson Mechanical to cover the entirety of our Todd Williams Memorial Scholarship!

On top of the support from our own members, we have received enormous support from our parent chapter, Golden Gate ASHRAE. I am happy to announce that REASHRAE & GGASHRAE have finalized and signed a Memorandum of Understanding (MOU) that will help aid a successful relationship for years to come! This MOU outlines agreed upon support and responsibilities between the two organizations that guide our financial, resource, and event support. I can't wait to see the great things that will come from this MOU.

With our finances secured for the 2020-2021 year, we were able to offer 5 total scholarships totaling to \$7,500 to graduating high school



**Harrison Nichols**  
REASHRAE  
President 2020-2021

seniors who are headed to 2- or 4-year colleges to study in a field related to the mission of ASHRAE. Take a look at the recap prepared by our Scholarship Chair, Logan McGowan. Logan did an amazing job this year, I am happy to have him involved on the board.

As a past scholarship chair myself, I am so happy we were able to continue the program this year, even during these trying times. Being able to support the engineers of the future is one of the most gratifying reasons why I serve ASHRAE. We appreciate the support, which keeps this tradition going and growing.

Like I said earlier, I think it's safe to say we can finally see some light at the end of the tunnel. I would think before 2021 is over, we will be able to safely host events in person. If this is the case, we will have some exciting events to come. We are hoping for a big Golf Tournament in the Fall, and maybe even another smaller Golf Tournament in late Spring (COVID pending). Be on the lookout for some announcements in the near future!

Our upcoming meeting on March 10<sup>th</sup> features the current ASHRAE National President, Chuck Gullledge. This will be a joint meeting with Golden Gate and San Jose ASHRAE. I look forward to seeing you all there, virtually!

Thanks for all the hard work and support this year. From all of us on the board we wish you a happy and healthy 2021. Let's make it a great year!

Sincerely,  
Harrison Nichols  
REASHRAE President

# Congratulations 2021 REASHRAE Scholars!

By Logan McGowan



## Kayla Del Rosario

*Todd Williams Scholarship  
Montgomery High School*  
Plans to pursue a Master's degree in Mechanical Engineering and work in a managerial position.

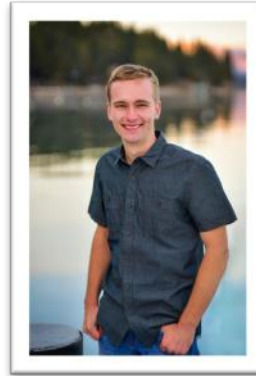

## Luke Baird

*Casa Grande High School*  
Wants to pursue a Bachelor's degree in Environmental Engineering and start his own e-waste recycling company.



## Aaron Beaubé

*Casa Grande High School*  
Wishes to pursue a Bachelor's degree in mechanical or electrical engineering and work as a professional engineer at a manufacturing company.



## Harper McClain

*St. Helena High School*  
Hopes to pursue a degree in Environmental Studies and perform research to help solve environmental problems.



## Vanessa Chen

*Vintage High School*  
Wishes to pursue a degree in physics and work as a scientist, engineer or teacher.



## Make a Donation

Please consider donating to support the continuation of the Redwood ASHRAE scholarship program.

[Donate via PayPal](#)

## Annual Golf Tourney Postponed

Due to the uncertainty around COVID, we continue to make the difficult decision to postpone our annual REASHRAE Golf Tournament to a later date. We are still looking at late Spring as a date to possibly host a small golf tournament event. We are hoping by the Fall we will be able to host the full Golf Tournament event. We continue to monitor county and state regulations, and will make our decision based on those guidelines. It's finally safe to say we can see some light at the end of the tunnel. We feel confident that we will be able to host at least one event this year. Stay tuned for more details.



**POSTPONED - New Date TBD**  
**Refrigeration Site Visit**



# Upcoming Event: CO<sub>2</sub> Chiller and Thermal Energy Storage

Modernize Existing Glycol Process Chillers Plant

*CO<sub>2</sub> Chiller rack w/pumping system and Thermal Energy Ice Storage w/Heat Recovery  
 160 Chiller with 600 Ton-hr of Thermal Ice storage producing 33 Deg F process cooling fluid*

**MAJOR EQUIPMENT**

- Adiabatic Gas Coolers
- CO<sub>2</sub> Chiller w/ Heat Reclaim
- Thermal Energy Ice Storage Tank
- Custom Pump Skid
- Brazen Plate Heat Exchangers

Heat Reclaim 1,800, MBH  
 110 Deg F pre-heating  
 boiler feed water



Mark your calendars for a tour of the chiller and energy storage facilities at Amy's Kitchen. More information coming soon!

**Location:**  
 Amy's Kitchen, Santa Rosa

**Schedule:**  
 Afternoon, time TBD  
 Possible post-tour Happy Hour at Russian River Brewing

**Tickets:**  
 TBD

**Please register:**  
 TBD

Modernize Existing Glycol Process Chillers Plant

*CO<sub>2</sub> Chiller rack w/pumping system and Thermal Energy Ice Storage w/Heat Recovery  
 160 Chiller with 600 Ton-hr of Thermal Ice storage producing 33 Deg F process cooling fluid*



Modernize Existing Glycol Process Chillers Plant

*CO<sub>2</sub> Chiller rack w/pumping system and Thermal Energy Ice Storage w/Heat Recovery  
 160 Chiller with 600 Ton-hr of Thermal Ice storage producing 33 Deg F process cooling fluid*

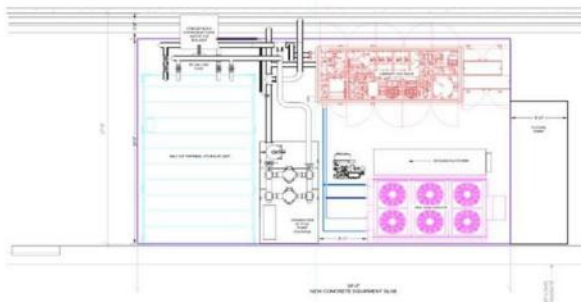

Modernize Existing Glycol Process Chillers Plant

*CO<sub>2</sub> Chiller rack w/pumping system and Thermal Energy Ice Storage w/Heat Recovery  
 160 Chiller with 600 Ton-hr of Thermal Ice storage producing 33 Deg F process cooling fluid*



# ASHRAE

## NOT A NATIONAL ASHRAE MEMBER? JOIN US!



By Mike Scofield, Membership Chair for Redwood Empire ASHRAE Section

Your membership in ASHRAE puts you in touch with over 53,000 members in over 170 Chapters worldwide. This group includes Consulting Engineers, Mechanical Contractors, Building Owners, Manufacturing Companies, Educational Institutions, Research Organizations, Architects, Government officials, and all concerned with HVAC&R for the Built Environment.

Join online at <http://www.ashrae.org/join>

### LEVELS OF MEMBERSHIP ARE AS FOLLOWS:

- **ASHRAE Member (\$206)** is available for anyone with 12 years or more ASHRAE approved experience in the HVAC&R Industry.
- **Associate Member (\$206)** is available for anyone with less than 12 years of experience in the HVAC&R Industry.
- **Affiliate Member\* (\$52 first year, \$78 second year and \$103 third year)** is available for first time members under the age of 30 years. This is an excellent way for the young Design Professional to become involved with ASHRAE at a lower cost. \*This membership does not include the ASHRAE Handbook.

**Questions:** Contact [membership@ashrae.org](mailto:membership@ashrae.org)

Don't forget to select your local **Golden Gate Chapter** when you join National Society! (\$60)

### Your ASHRAE membership includes:

- ASHRAE Handbook the year you join and each year you remain a member.
- Monthly *ASHRAE Journal* magazine.
- Discounts on attending ASHRAE annual EXPO and Technical Meetings.
- Discounts on over 300 of the HVAC&R Industry Technical Publications.
- Discounts for Continuing Education Courses through the ASHRAE Learning Institute.

## Join the Redwood Empire ASHRAE Section

### I'll Join RE-ASHRAE for 2020-2021

Send your check of \$25 to P.O. Box 5665, Santa Rosa, CA. 95402 or bring your check to the next REASHRAE meeting. Make checks payable to Redwood Empire ASHRAE. Thanks!

Name: \_\_\_\_\_  
 Company: \_\_\_\_\_  
 Company Address: \_\_\_\_\_  
 City, State, Zip: \_\_\_\_\_  
 Email: \_\_\_\_\_  
 Work Phone: \_\_\_\_\_ Work Fax: \_\_\_\_\_  
 Home Phone: \_\_\_\_\_

Please use the following address for ASHRAE correspondence (if different than above):

Address: \_\_\_\_\_  
 City, Zip: \_\_\_\_\_

Currently I am a member of:

- ASHRAE National Society Member
- ASHRAE Golden Gate Chapter
- ASHRAE \_\_\_\_\_ Chapter

## The Grapevine

Is published quarterly by the Redwood Empire Section of the Golden Gate Chapter of ASHRAE. We encourage submissions from members and non-members alike that might be of interest to our readers. Items for publication should be submitted directly to the Editor and President via email.

If you have questions or comments about the Grapevine, please contact the Editor:

William H. Martin III

[wmartin@norman-wright.com](mailto:wmartin@norman-wright.com)

### The Grapevine

Editor

William H. Martin III

Graphic Design

Nicole M. Travis

### REASHRAE Board, 2019-2020

President

Harrison Nichols

Treasurer

Adrian Giovenco

Secretary

Logan McGowan

Past President

William H. Martin III

Director

Mike Scofield

Board of Governors:

Gary Harbison

### The Usual Suspects

Michelle Whitsitt

Geoff Dubois

Kent Kawakami

Please visit our website at

[www.reashrae.org](http://www.reashrae.org)

\*The mention of any business, product or service in this newsletter does not imply endorsement by ASHRAE.

## Events Calendar

**Mar.10, 2021** – REASHRAE Joint Meeting with SJ and GG ASHRAE

**TBD 2021** – Refrigeration Site Visit, Joint Event with GG ASHRAE

**Jun. 26-30 2021** – National ASHRAE Annual Conference – Phoenix, AZ

**Send us your ASHRAE-related events!**

### 2021-2022 Board Nominees:

Below are the current nominations for REASHAE board. Please nominate candidates.

*President* – Harrison Nichols

*Secretary* – Logan McGowan

*Treasurer* – Geoff DuBois

*Director* – Mike Scofield

*Golf Tournament Committee* –

Adrian Giovenco

Gary Harbison

*Board of Governors* –

Billy Martin

Michelle Whitsitt

Kent Kawakami

Maya Salabasheva